

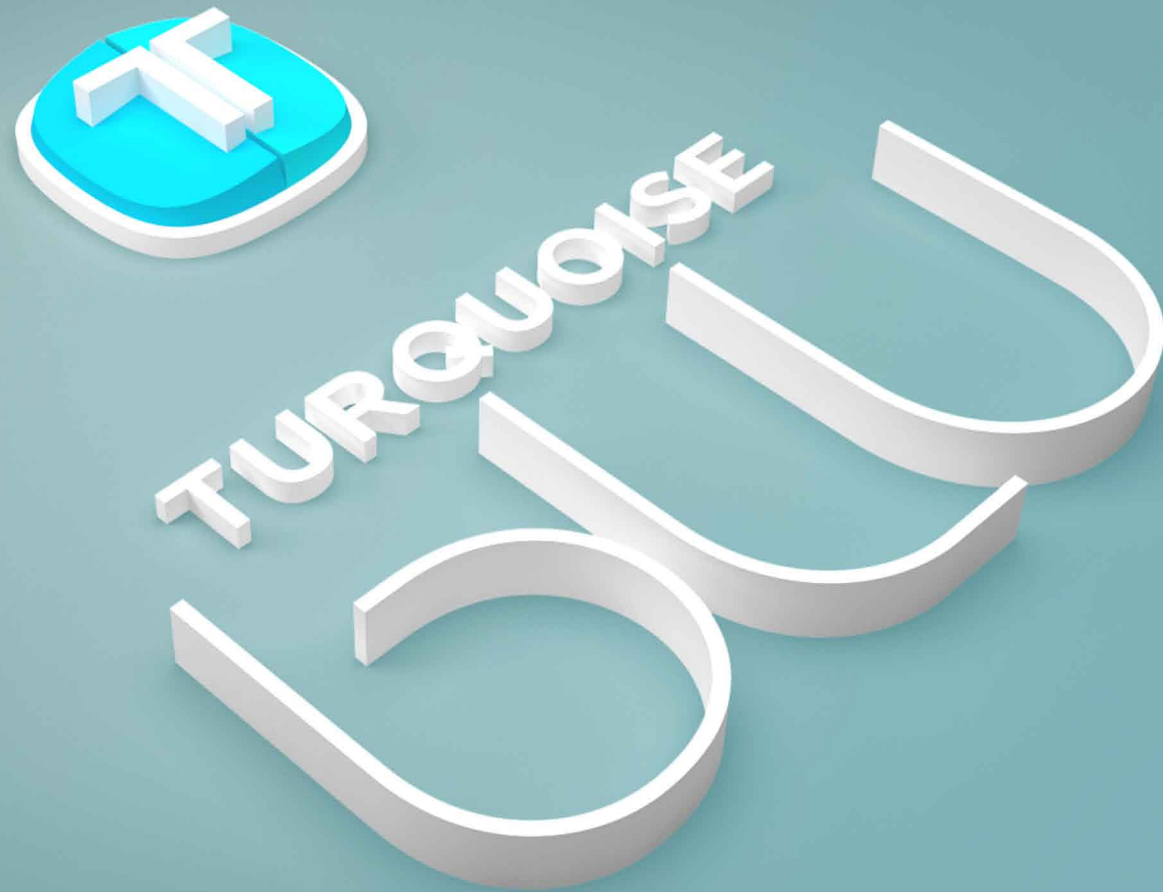

THE LIFESTYLE YOU
DESIRE
IS HERE!

3 BHK LUXURIOUS APARTMENTS



Innovation Breathes in Blu!

With magnificence and luxury combining to elevate your lifestyle, Turquoise Blu is a comprehensive lifestyle avenue that blends impeccable design, wholesome amenities, and functional spaces for residents who deserve and desire to live an ideal life.



TURQUOISE
LOCATION

TURQUOISE
AMBIANCE

TURQUOISE
ACTIVITIES

TURQUOISE
HOMES



TURQUOISE BLU

3 BHK LUXURIOUS APARTMENTS





THE BRILLIANT BLU

LOCATION

Located in the strategic and developing area of Shela, connecting South Bopal and SG Road, Turquoise Blu provides its residents the connectivity to varied clubs, supermarkets, restaurants, hospitals, schools, and corporate offices.



CLUB



MALL



HOSPITAL



EDUCATION

THE LOCATION LANDSCAPE

Turquoise Blu is situated in the heart of every important place or region that residents would need to access in close proximity.

NEAREST AREA LIST



STRATEGIC ENTERTAINMENT AVENUES
0.3 km | 2 Min. to **Club O7 (Gujarat biggest Club)**
6 km | 10 Min. to **Karnavati Club**
6 Km | 15 Min. to **City Gold Theatre**
8 km | 15 Min. to **Rajpath Club**
Upcoming 70000 Sq. Yard Auda Garden with the lake



DIVINE PRAYER AND COMMUNITY HALL
400 m | 3 min. to **Government Shela Auditorium**
1 km | 5 min. to **Biggest Jain Derasar of Bopal SOBO & Shela**
1 km | 5 min. to **Raja Agrasen Community Hall**



EDUCATIONAL SCHOOLS AND COLLEGES
1 km | 5 min. to **Apollo International School**
1 km | 10 min. to **Shanti Business School**
3 km | 10 min. to **Mother Teresa Memorial School**
3 km | 10 min. to **MICA Ahmedabad**
5 km | 15 min. to **L.J Institute of Engineering And Technology**



WELL-EQUIPPED HOSPITALS AND HEALTHCARE CLINICS
4 km | 15 min. to **Krishna-Shalby Hospital**



COMPREHENSIVE SUPERMARKETS
4.8 km | 11 min. to **Metro Whole Sale Super Market**
5 km | 15 min. to **Star Bazar & Reliance Mart**
6 km | 20 min. to **D-Mart**



DEVELOPING AREAS NEARBY
3 km | 15 min. to **South Bopal**
3 km | 15 min. to **Ghuma**
3 km | 15 min. to **Shantipura**
8 km | 20 min. to **Sanand**

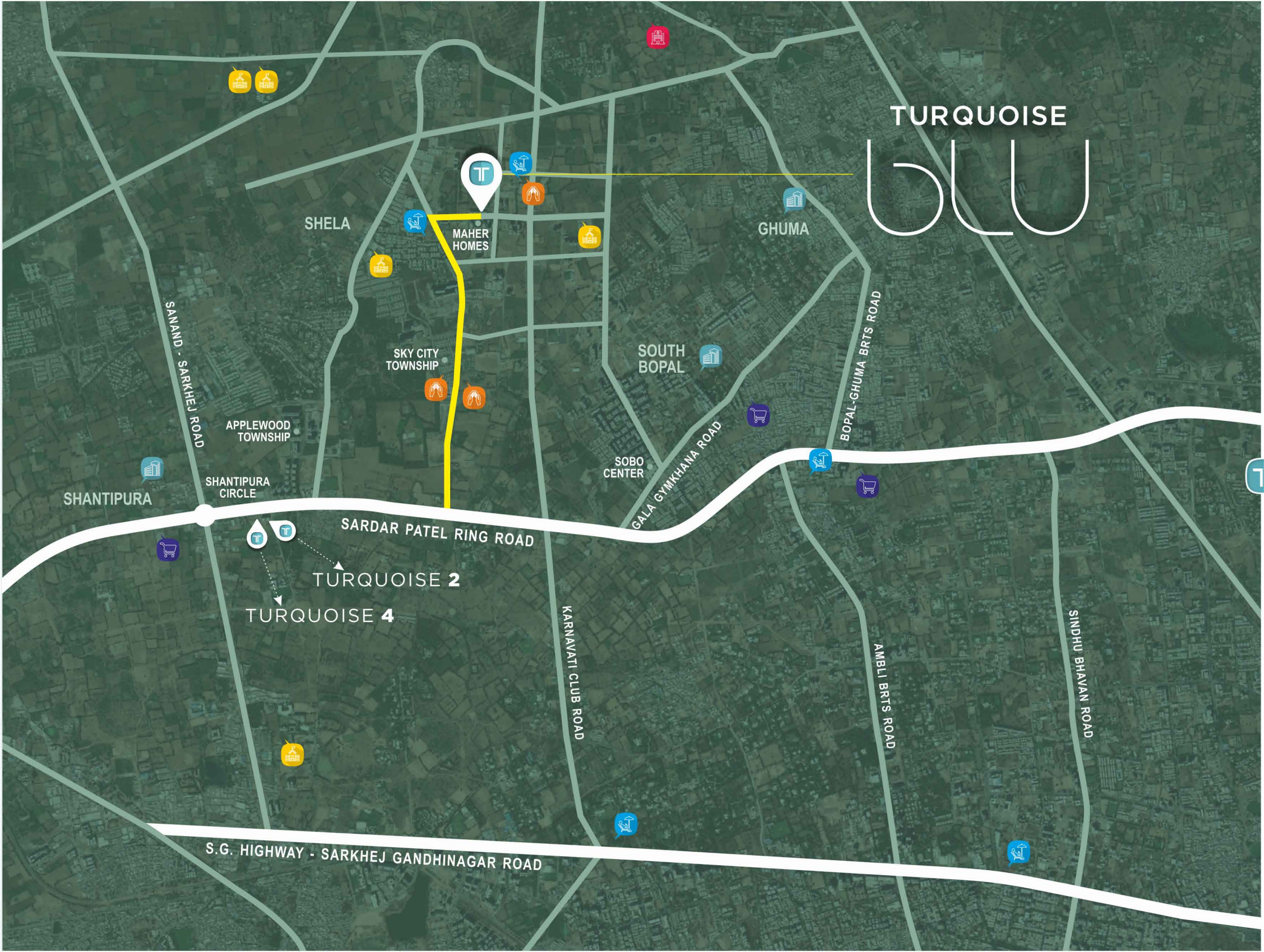





THE BLU

AMBIENCE

Turquoise Blu brings several elements to the residential space that elevate the environment and its pedigree by several notches. Gazebos, walkways, terrace sittings, and green spaces rule the ambiance that aid residents to live their lives at the next level.



GARDEN



GAZEBO



WALKWAY



**TERRACE
SITTING**



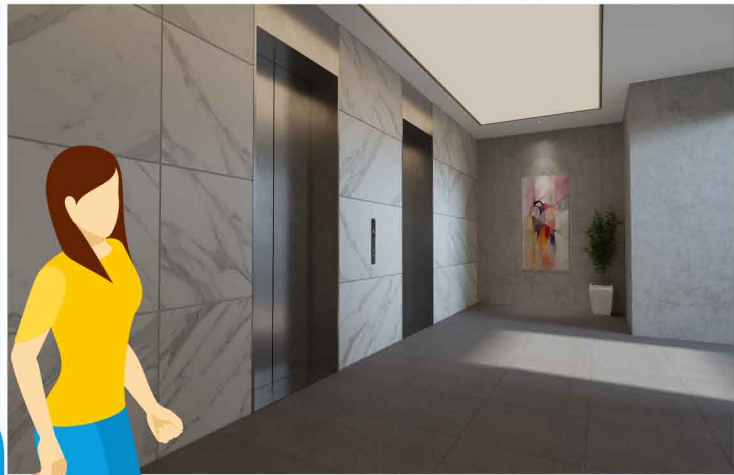



THE BLU ACTIVITIES

Turquoise Blu hosts the finest activity zone that span indoor and outdoor games, society banquet hall for hosting celebrations, a spacious gymnasium, and a well-stocked library. Residents can regale themselves in a plethora of activities that enrich their lifestyle.



**INDOOR
OUTDOOR
GAMES**



**SOCIETY
BANQUET
HALL**



**GYM
YOGA ROOM**



**LIBRARY
THEATER**



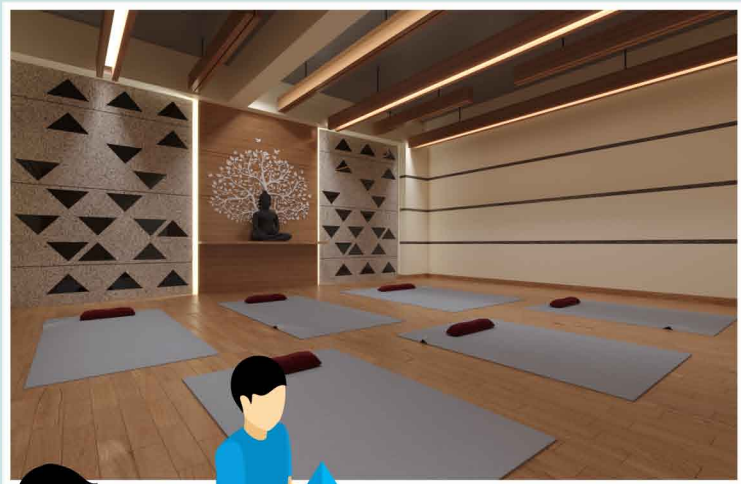

SPECTACULAR BLU AMENITIES

Explore the varied amenities and facilities that Turquoise Blu offers its residents that ensure that they live the ideal “Blu” lifestyle!

- Car Wash Area
- 2 Level Basement
- Barbeque Corner
- 24 x 7 Security
- Lounge
- Changing Room
- Society Hall
- Yoga Room
- Banquet Hall
- Standing Game Area





THE BLU RESIDENCE

With a residential lifestyle blending leisure and luxury of the highest order, Turquoise Blu ensures an ideal living experience for residents that is Vastu-compliant, permeates cross-ventilation options, and a large 10 ft. ceiling height and lounge space.



**10 FEET
CLEAR HEIGHT
CEILING**



VASTU



**CROSS
VENTILATION**



LOUNGE

SITE LAYOUT PLAN



Lawn With Gazebo Sitting



Sand Pit



Deck

Car Wash Area



24 X 7 Security

Box Cricket Pitch



Seating Alongside Parapet with Trellis



Meditation Deck



Semi Covered Seating



Artificial Grass Lawn



2 Level Basement

10 Ft. Clear Height Ceilings













Barbeque Corner



Multipurpose Court with Basketball Net



FIRST FLOOR PLAN

- **Library**
- **Yoga Deck**
- **Indoor Game Room**
- **Mini Theatre**
- **Banquet Hall**
- **Society Hall**
- **Gym**
- **Standing Game Area**
- **Lounge**
- **Changing Room**



TYPICAL FLOOR PLAN

SPECIAL FEATURES

- 

Provision of AC points in Bedrooms
- 

Concrete/ Paver road with trimix finish
- 

Fire fighting system
- 

Ample quantity of water storage
- 

Underground and overhead tanks
- 

Internal walls finished with wall putty
- 

Weather shield acrylic emulsion paint for exteriors
- 

Security cabin
- 

Fully Automatic high speed lifts
- 

CCTV monitoring of common areas
- 

Telephones, DTH TV inclusive of all the rooms in the apartments
- 

Power backup with D.G Sets for common areas
- 

Seismic structural design
- 

Basement parking facility
- 

Vastu compliant design

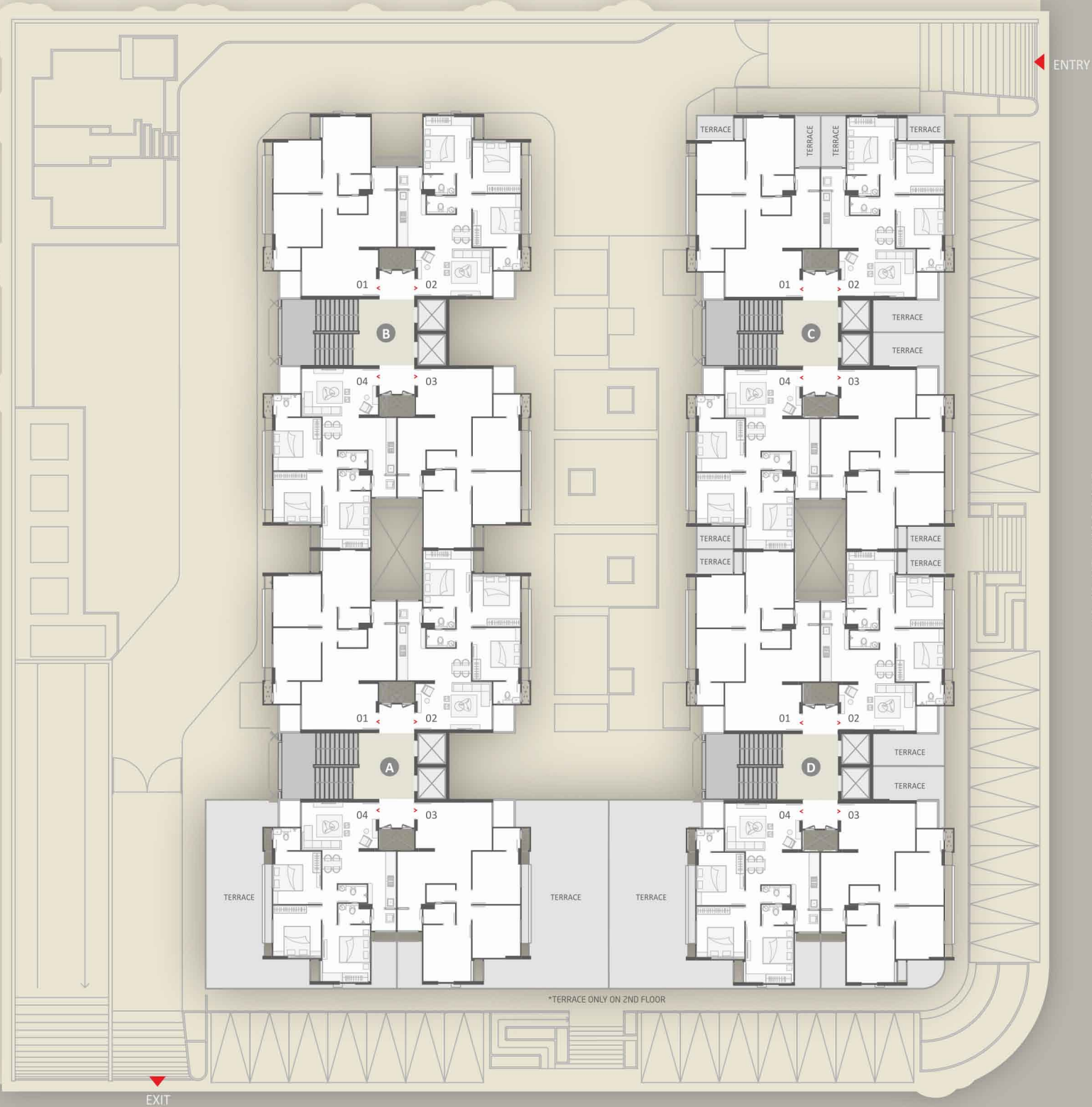

UNIT PLAN

1	VESTIBULE	3'6" x 6'0"
2	LIVING ROOM	16'0" x 10'0"
2A	BALCONY	4'3" x 5'6"
3	COMMON TOILET	6'0" x 3'9"
4	KITCHEN	7'9" x 11'9"
4A	WASH AREA	5'0" x 4'6"
4B	STORAGE SPACE	1'0" x 4'6"
5	DINING AREA	7'6" x 6'9"
6	BEDROOM - 1	10'0" x 11'0"
6A	TOILET - 1	5'9" x 4'6"
7	BEDROOM - 2	10'0" x 11'0"
8	BEDROOM - 3	10'0" x 12'0"
8A	TOILET - 3	6'9" x 4'3"



SPECIFICATIONS



RCC

- Structure designed with earthquake resistant frame
- Block masonry & weather resistant structure



FLOORING

- Vitrified flooring in apartment
- Designer tiles in Bathrooms, Verndah and Utility area
- Lobby with Vitrified tiles and Granite



ELECTRIFICATION

- Concealed three phase electrical copper wiring
- Modular switches
- ISI wires, MCB and ELCB



KITCHEN

- Adani PNG Connection Piping in Kitchen
- Stainless steel sink
- Dado tiles
- Granite Platform



TOILETS / BATHROOMS

- Concealed Plumbing
- Health Faucet
- Bathroom wall cladding with designer series tiles
- Wooden frames for Bathrooms
- Branded sanitary wares and CP fittings



FIRE PREVENTIVE MEASURES

- Entire design comprises of the International Building Code (IBC)
- Automatic fire sprinklers installed in the hollow plinth
- Manual panic alarm provided on each floor for fire safety





Ratna[™]
RISING • REALTY

LEGACY OF OVER 3 DECADES

Spanning three decades of operations, Ratna Group has managed multiple real estate initiatives through foresight, vision, and excellence. The group stands by its promise and commitment to be transparent in its dealings, upholding quality, value, and security of every project to the utmost levels.

PAST PROJECTS



RATNA BIZ PARK
@ Rakhiyal



TURQUOISE
@ Panchvati Circle



RATNA BUSINESS SQUARE
@ Ashram Road



RATNA PARADISE
@ Vaishnodevi Circle



RATNA HIGH STREET
@ Naranpura



RATNA ARTEMUS
@ C.G. ROAD
RERA No.: PR/GJ/AHMEDABAD/AHMEDABAD CITY/AUDA/CAA00556/301017
www.gujrera.gujarat.gov.in

CURRENT PROJECTS



TURQUOISE 2
@ Opp. Decathlon, SP Ring Road
RERA No.: PR/GJ/AHMEDABAD/AHMEDABAD CITY/AUDA/CAA00988/121217
www.gujrera.gujarat.gov.in



TURQUOISE 3
@ South Bopal to Bopal Road
RERA No.: PR/GJ/AHMEDABAD/AHMEDABAD CITY/AUDA/CAA04676/150119
www.gujrera.gujarat.gov.in



TURQUOISE 4
@ SP Ring Road, Opp Decathlon
RERA No.: PR/GJ/AHMEDABAD/AHMEDABAD CITY/AUDA/CAA06289/061119
www.gujrera.gujarat.gov.in



Re11
@ Iscon - Ambli Road
RERA No.: PR/GJ/AHMEDABAD/AHMEDABAD CITY/AUDA/CAA03185/190718
www.gujrera.gujarat.gov.in



ARTEMUS 2
@ Paldi - Bhatta
RERA No.: PR/GJ/AHMEDABAD/AHMEDABAD CITY/AUDA/CAA01474/010218
www.gujrera.gujarat.gov.in



AVION
@ Naranpura
RERA No.: PR/GJ/AHMEDABAD/AHMEDABAD CITY/AUDA/CAA04678/150119
www.gujrera.gujarat.gov.in



RATNABHUMI BUILDSPACES LLP,

CORPORATE OFFICE :

207, "Turquoise" Opp Center Point Panchwati,
C.G. Road, Ahmedabad - 380 006

SITE ADDRESS :

Turquoise BLU, Near Maher Homes,
OPP lane to Club O7, Shela, Ahmedabad - 380 058

Call : ☎️ 📞 80009 32012

www.ratnagroup.co.in

RERA Registration Number : PR/GJ/AHMEDABAD/
SANAND/AUDA/MAA06339/A1M/030221

www.gujrera.gujarat.gov.in

    / RATNAGROUP



NOTES

- Brochure shall not constitute a part of legal document and therefore no claim or objection or right can be raised by the customers based on this.
- The photographs & artist impression are for reference only.